

NU300E series

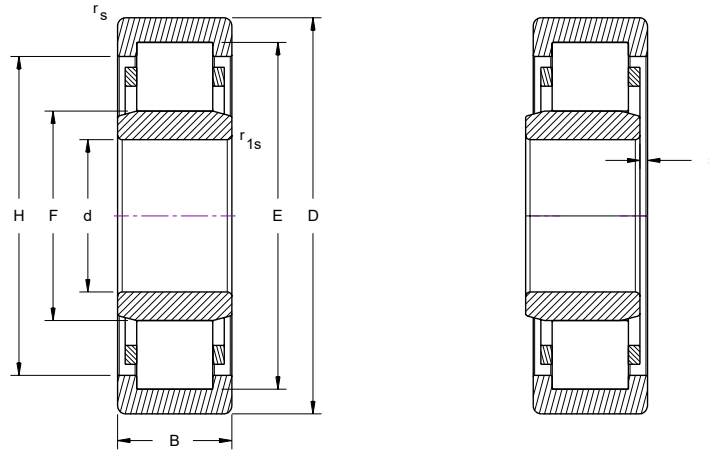

Bearing Number	Dimensions (mm)									Load Ratings (lbf)		Limiting Speed (RPM)	Weight (lbs)
	d	D	B	E	F	H	s*	r_s	r_{1s}	Dynamic	Static		
								min	min	Cr	Cor		
NU303E	17	47	14	40.2	24.2	27.6	1.2	1.0	0.6	4833	3822	16000	0.3
NU304E	20	52	15	45.5	27.5	31.3	1.0	1.1	0.6	7081	6070	14000	0.3
NU305E	25	62	17	54.0	34.0	50.6	1.5	1.1	1.1	9330	8430	12000	0.5
NU306E	30	72	19	62.5	40.5	59.2	1.2	1.1	1.1	11915	11240	10000	0.8
NU307E	35	80	12	70.2	46.2	66.6	0.6	1.5	1.1	15062	14613	9000	1.0
NU308E	40	90	23	80.0	52.0	75.9	1.3	1.5	1.5	18434	17985	7500	1.4
NU309E	45	100	25	88.5	58.5	84.1	1.0	1.5	1.5	22256	22706	6700	2.0
NU310E	50	110	27	97.0	65.0	92.5	1.7	2.0	2.0	25179	26078	6300	2.4
NU311E	55	120	29	106.5	70.5	101.4	1.8	2.0	2.0	31024	32372	5600	3.2
NU312E	60	130	31	115.0	77.0	109.6	1.8	2.1	2.1	34396	36419	5000	3.9
NU313E	65	140	33	124.5	82.5	118.6	1.5	2.1	2.1	41140	43838	4800	4.9
NU314E	70	150	35	133.0	89.0	126.8	1.7	2.1	2.1	46535	50807	4500	6.0
NU315E	75	160	37	143.0	95.0	136.2	1.2	2.1	2.1	54629	60024	4000	7.3
NU316E	80	170	39	151.0	101.0	143.9	0.7	2.1	2.1	58900	65419	3800	8.5
NU317E	85	180	41	160.0	108.0	152.7	1.3	3.0	3.0	66993	76660	3600	10.3
NU318E	90	190	43	169.5	113.5	161.6	1.5	3.0	3.0	71939	80931	3400	11.6
NU319E	95	200	45	177.5	121.5	169.6	1.4	3.0	3.0	75985	88125	3400	13.7
NU320E	100	215	47	191.5	127.5	181.9	1.2	3.0	3.0	87451	98691	3200	16.4
NU322E	110	240	50	211.0	143.0	200.9	1.3	3.0	3.0	103862	121622	3000	23.1
NU324E	120	260	55	230.0	154.0	218.7	3.5	3.0	3.0	127017	150172	2800	28.7
NU326E	130	280	58	247.0	167.0	235.2	3.5	4.0	4.0	132637	156017	2600	35.3
NU328E	140	300	62	264.0	180.0	251.7	5.2	4.0	4.0	146126	179398	2400	44.3
NU330E	150	320	65	283.0	193.0	269.8	5.5	4.0	4.0	173553	212220	2200	59.1
NU332E	160	340	68	300.0	204.0	286.0	5.6	4.0	4.0	185467	224809	2000	70.1
NU334E	170	360	72	318.0	218.0	301.6	6.0	4.0	4.0	211995	264713	2000	83.8
NU336E	180	380	75	335.0	231.0	319.8	6.1	4.0	4.0	224809	282135	1800	96.8
NU338E	190	400	78	353.0	245.0	336.0	6.3	5.0	5.0	251786	321477	1800	111.6
NU340E	200	420	80	370.0	258.0	351.8	6.3	5.0	5.0	265275	343958	1600	126.3

* Permissible axial displacement